

Cabinet Adaptor Kit for Mounting a Digitus Smart Handle in a 50x50x50 Cut-out

Digitus offers a wide range of adaptor kits for cabinets that aren't designed for swinghandles. The kits allow any Digitus Smart Handle to be used on these cabinets without modifications to the cabinet.

Before



After



Designed specifically for cabinets with a 50x50x50 cut-out, where the customer does not want to modify the cut-out section, the db505050KIT-SH allows a dbSmart Handle to be seamlessly integrated.

Adaptor Kit with dbELock Handle Assembly

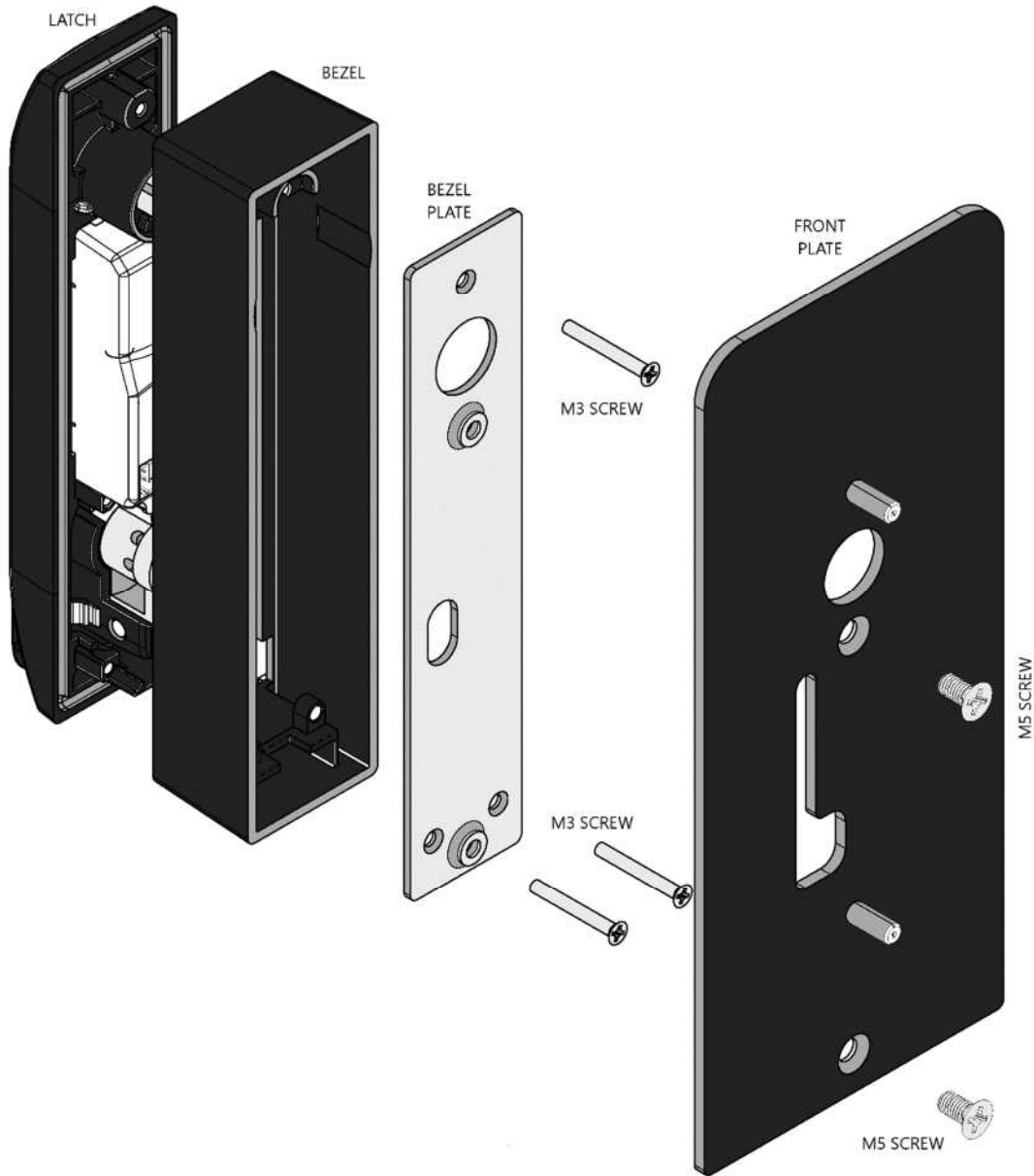

Order the Adaptor Kit with any Digitus dbELock and Digitus will fully assemble the Adaptor Kit with the Handle, ready for easy installation onto your cabinet.

Adaptor Kit Installation

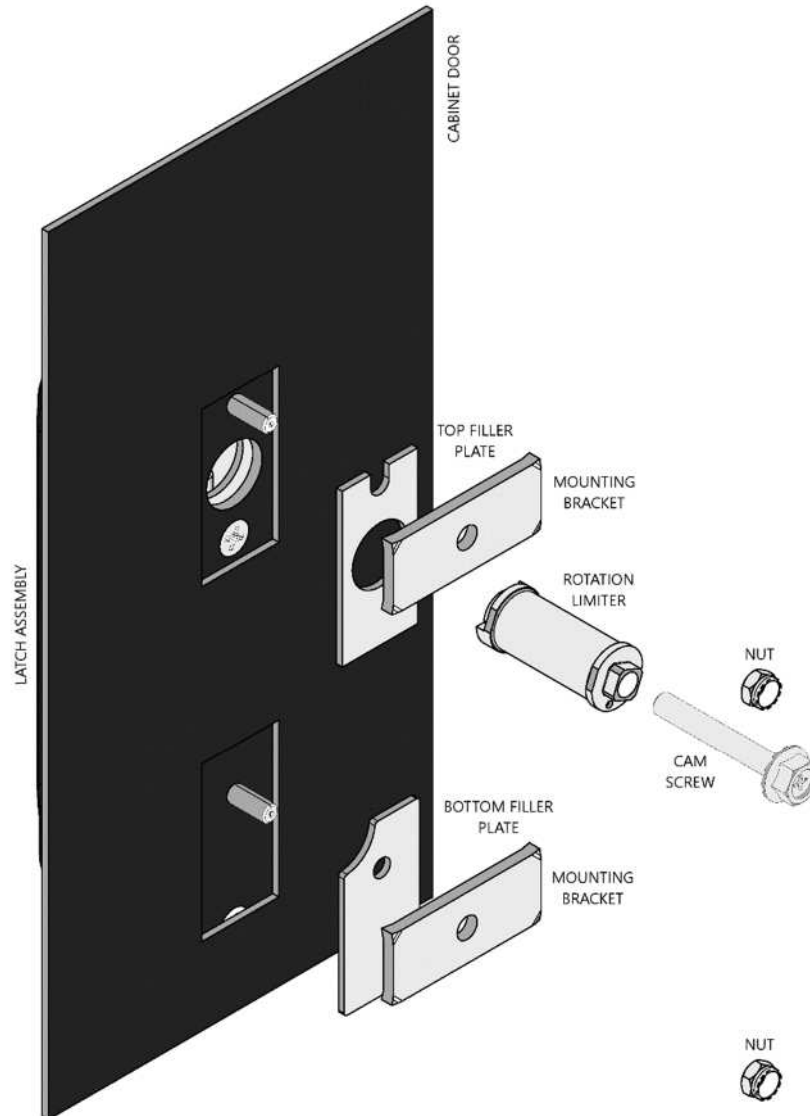

The fully assembled Adaptor Kit ready to be installed.
All assembly hardware is included.